

## **TANK SPECIFICATIONS**

### **CAPACITY:**

2000 GALLONS = 1250 & 750

### **DIMENSIONS:**

LENGTH = 154" AT TOP,

148" AT BOTTOM

WIDTH = 84" AT TOP,

78" AT BOTTOM

OVERALL HEIGHT = 62"

DEPTH BELOW INLET = 48"

DEPTH BELOW OUTLET = 46"

### **INLET AND OUTLET BAFFLES:**

POLYETHELENE w/STAINLESS  
STEEL CONNECTORS

### **INLET BAFFLE:**

15" (8" ABOVE LIQUID LEVEL,

7" BELOW LIQUID LEVEL) 16.25%

### **OUTLET BAFFLE:**

25 1/4" (8" ABOVE LIQUID LEVEL,

17 1/4" BELOW LIQUID LEVEL) 40%

### **LIQUID CAPACITY:**

1250 LIFT = 29.76 GAL PER INCH

750 LIFT = 17.86 GAL PER INCH

43" LIQUID DEPTH

ALL ACCESS OPENINGS ARE  
24" I.D.

ALL BAFFLES HAVE A MINIMUM 1"  
AIR SPACE BETWEEN COVER AND  
TOP OF BAFFLE

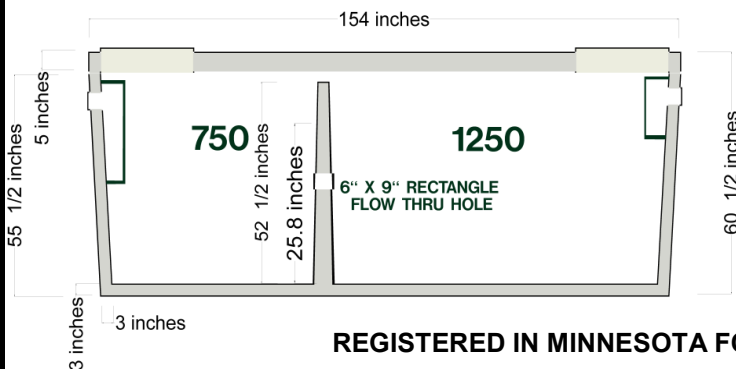
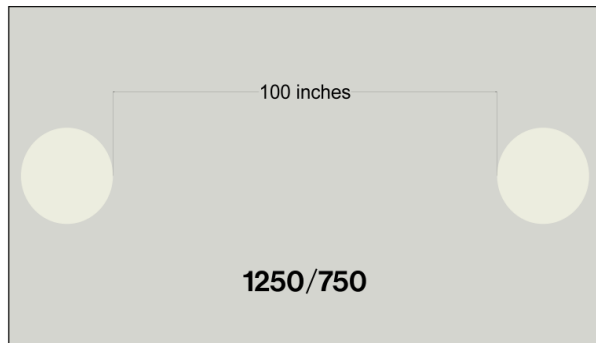
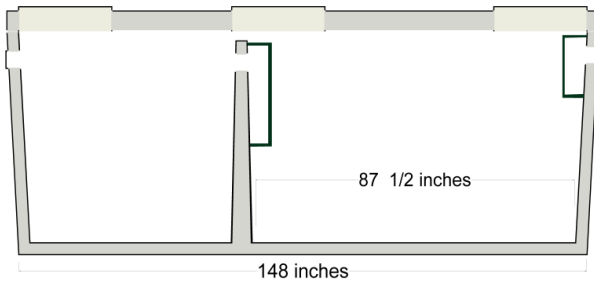
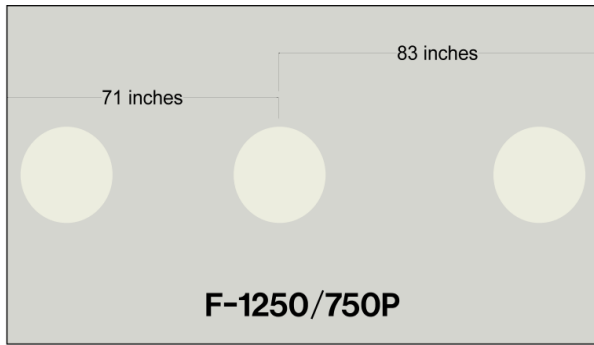

REGISTERED IN MINNESOTA FOR SEVEN FEET OF COVER ON TOP OF THE TANK.

### **MODEL:**

**DARWIN F-1250/750P**

**DARWIN 1250/750**

SEPTIC TANK/HOLDING TANK

2417 GALLONS

TANK WEIGHT 14,710 LBS

**Precast  
Systems  
Inc.**

PO Box 56, Darwin MN 55324  
320-693-8440 [www.darwinconcrete.com](http://www.darwinconcrete.com)